

Product

CB80010CP - Nulo Concealed Thermostatic Shower Dual Outlet

Technical Specification

Max Inlet Pressure (static):	10 Bar
Min Inlet Pressure (dynamic):	0.4 Bar
Max Inlet Temperature:	85°C
Factory Pre-set Temperature:	38°C with max temp stop
Temperature Stability:	+/-2°C
Inlet Connections:	15mm
Outlet Connections:	15mm
Min Temperature Differential Between Hot Inlet & Mixed Outlet to Achieve Cold Water Failsafe:	10°C

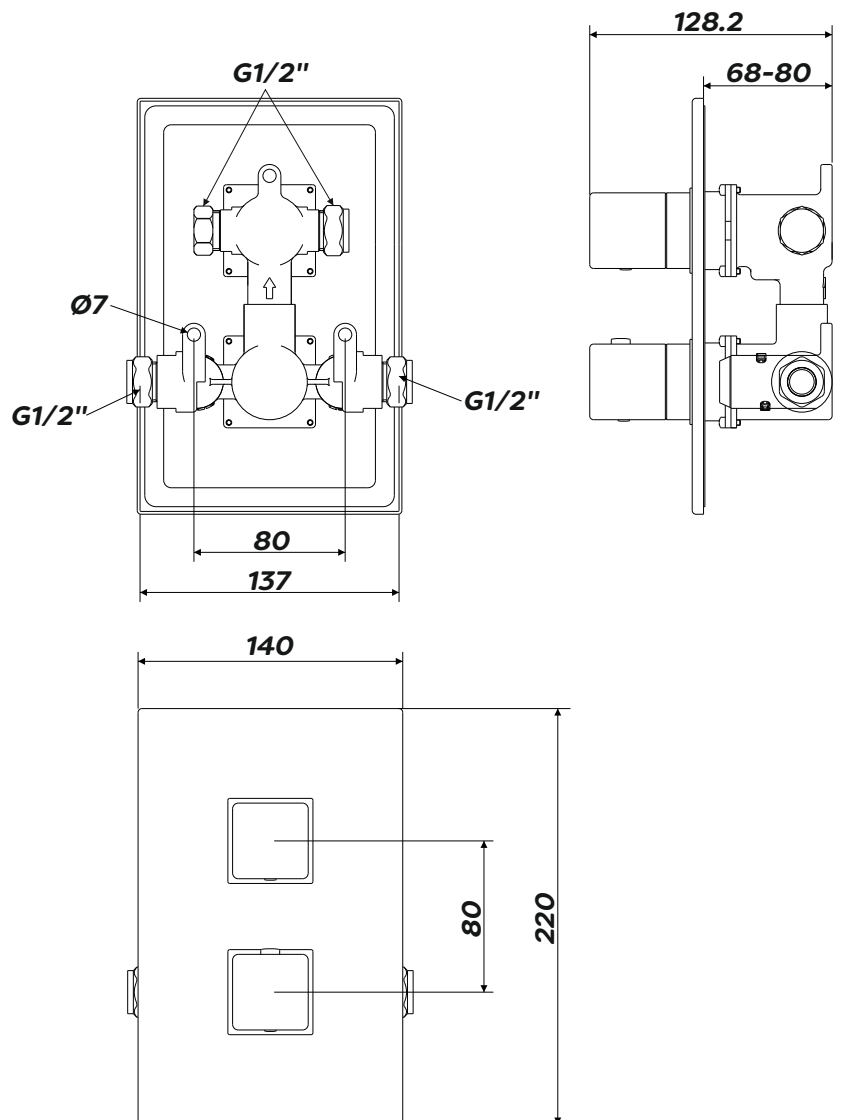

Additional Information

Thermostatic Protection

Minimalistic Style

Range of Shower Kits to Suit

Concealed Outlet

Easy to Operate Sequential Handles

TMV2 Approved

WRAS Approved



Scan for Installation & Maintenance Instructions

Intatec, Airfield Industrial Estate, Hixon, Stafford, ST18 0PF

T. 01889 272180 F. 01889 272181 E. sales@intatec.co.uk

www.intatec.co.uk

05/22
E&OE