

FLOW RATE SELECTION TABLE

Activflo Lite operates best at its optimum flow rate. The maximum flow rate is the most water passing through the valve at which it still remains effective.

CODE	AFL015	AFL022	AFL028
CONNECTIONS - COMPRESSION MM	15	22	28
MAXIMUM FLOW RATE L/M	36	47	132
OPTIMUM FLOW RATE L/M	12	16	44

DIMENSIONS

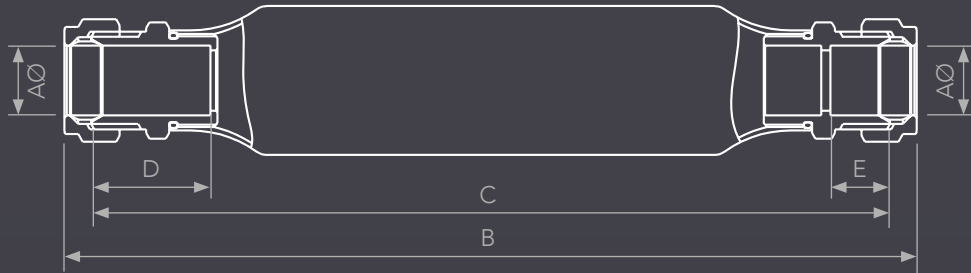

	AFL015	AFL022	AFL028
AØ	15	22	28
B	186	222	270
C	174	207	253
D	26	26	26
E	13	13	13

AVAILABLE FROM

inta

Find out more at
activ-tec.com

Activ
TEC
ActivTec Limited
Airfield Industrial Estate
Hixon, Stafford, ST18 0PF

E&OE 06/2018

ActivFlo LITE

WATER CONDITIONER



- ✓ PREVENTS LIMESCALE
- ✓ IMPROVES WATER QUALITY
- ✓ 8 YEAR PRODUCT LIFE EXPECTANCY

WRAS
APPROVED PRODUCT

5 YEAR
Guarantee

INTRODUCTION

Activflo Lite is the latest addition to the range of Activflo Water Conditioners. It has been specifically designed to help combat against limescale build-up in homes and systems with hard water supplies.

HOW DOES ACTIVFLO LITE WORK?

Water enters the Activflo Lite and is immediately greeted by its revolutionary turbulent amplifier which sends the water into a spinning motion to help ensure maximum efficiency of the water being processed.

The water is then sent through a series of Zinc anodic channels, which when combined with Activflo's natural electrolytic process helps change the calcite mineral to the smooth, nonadhering Aragonite. This Aragonite crystal has a smooth external surface which makes it unlikely to adhere to domestic pipework, boilers and appliances. It remains in suspension until it is then passed down the drain. If at any point these particles made their way onto a surface, they become much easier to remove without any need for cleaning agents or aggressive cleaning action.

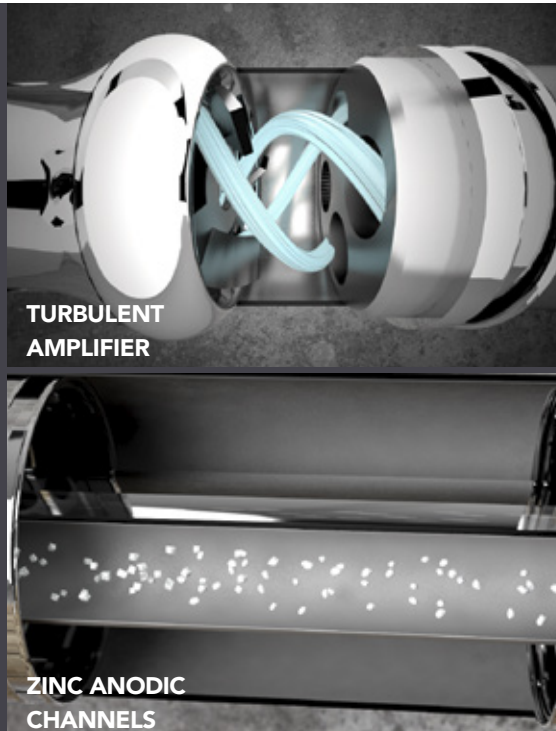

ARE YOU PART L COMPLIANT?

DID YOU KNOW

By fitting an Activflo water conditioner installers can improve their Part L compliance, as the Building Compliance Guide states the following: "Where the mains total water hardness exceeds 200 parts per million, provision should be made to treat the feed water to water heaters and the hot water circuit to reduce the build-up of limescale".

LIMESCALE IN THE UK

Hard water is measured by the amount of parts per million (PPM) of calcium and magnesium salts in the water supply. Limescale build-up in the supply can reduce flow rates, cause blockages, reduce system efficiency and leave hard to remove scale stains on external surfaces.

Recent research has suggested that just 1.6mm of scale in a heating system can reduce the efficiency of the system by 12%.

SOFT WATER	0-100 mg/l calcium carbonate
HARD WATER	100-200 mg/l calcium carbonate
VERY HARD WATER	200+ mg/l calcium carbonate



INSTALLATION AND OPERATION:

We recommend that ActivFlo Lite should be installed on the incoming cold water mains to the property, before any draw-off points, to ensure whole house protection.

The flow rate should be kept between the optimum and maximum flow rates shown on page four of this leaflet. This ensures expected performance levels can be met.

PRODUCT RANGE

- AFL028 ActivFlo Lite 28mm compression
- AFL022 ActivFlo Lite 22mm compression
- AFL015 ActivFlo Lite 15mm compression



- **INTERNAL SLIP SOCKET FOR EASE OF INSTALLATION**
- **8 YEAR PRODUCT LIFE EXPECTANCY**
- **EXTERNAL CHROME PLATED SURFACE**
- **TURBULENT AMPLIFIER TO ENSURE MAXIMUM EFFICIENCY**

