

inta

Concealed WC Cistern with Infra Red Flush IR2568

Installation and Maintenance Instructions

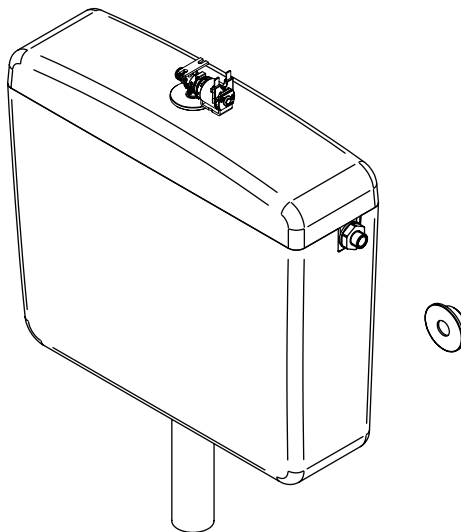

inta

Intatec Ltd

Airfield Industrial Estate

Hixon

Staffordshire

ST18 0PF

In this procedure document we have endeavoured to make the information as accurate as possible.

We cannot accept any responsibility should it be found that in any respect the information is inaccurate or incomplete or becomes so as a result of further developments or otherwise.

Tel: **01889 272 180**

Fax: **01889 272 181**

email: **sales@intatec.co.uk**

web: **www.intatec.co.uk**

Introduction

This installation guide has been produced for the IR2568 concealed WC with infra red flush. These instructions cover the installation, operation and maintenance. Please read the enclosed instructions before commencing the installation of this product, please note;

We recommend that the installation of any product is carried out by an approved installer.

The installation must be carried out strictly in accordance with the Water Supply (Water Fitting) Regulations 1999 and any local authority regulations.

If in doubt we recommend that you contact WRAS - Water Regulations Advisory Scheme on Tel: 0333 207 9030, your local water authority - details available on the WRAS website or the Chartered Institute of Plumbing and Heating Engineers on Tel: 01708 472 791.

All products MUST be re-commissioned to suit site conditions to ensure optimum performance levels of the product are obtained.

It is recommended, especially in hard water areas, that a water softener such as the ActivFlo or ActivFlo lite be fitted to reduce the risk of calcium deposits forming.

Products

Concealed WC with Infra Red Flush, Battery Operated

IR2568

Check Content

Before commencing remove all components from packaging and check each component with the contents list.

Ensure all parts are present, before discarding any packaging. If any parts are missing, do not attempt to install your Inta thermostatic tap until the missing parts have been obtained.

Components

Item	Component
1	Cistern with cover
2	Flush valve - installed in cistern
3	Inlet flow valve - installed in cistern
4	Solenoid valve
5	Infra red sensor
6	IP65 battery and battery box
7	Cable
8	Perspex tube
9	Flush pipe
10	Wall bracket, plastic plug and screw - 2 off

Dimensions

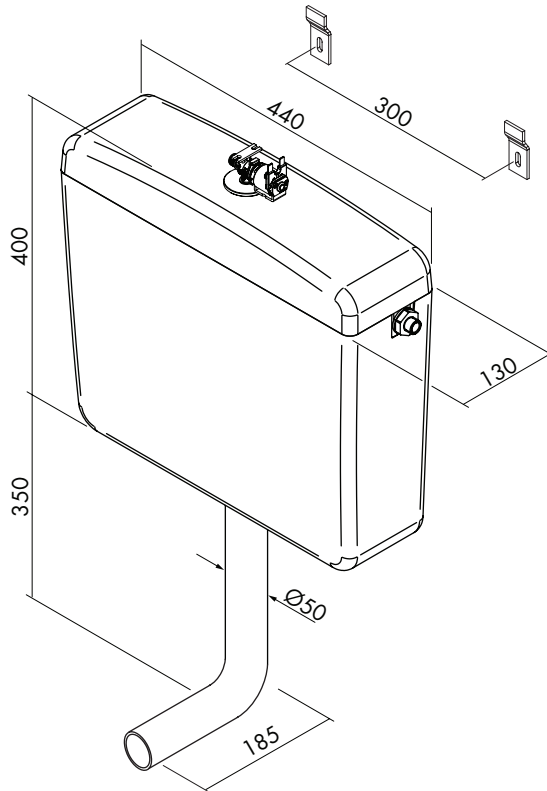

Technical Specification

Operating water pressure range:	1 to 8 bar (recommended 5 bar maximum)
Power supply:	6V lithium battery - CRP-2
Flush volume:	6 litres
Auto-flush:	every 24 hours from last flush

Operating

The water flush is activated by a hand wave 5 to 6 cm away from the infra red sensor.

Installation

Before commencing the installation ensure the wall on which the cistern is to be mounted is structurally suitable.

Drill two holes in the wall above the toilet pan approximately at 300mm centres.

Using the plastic wall plugs and screws provided fix the two brackets to the wall.

Hang the cistern onto the two brackets directly above the toilet pan and using the flush pipe connect to the toilet.

Connect the water supply to the cistern, a service valve must be installed in the supply pipe should future maintenance be required.

Do not turn on the water supply at this time.

Drill a hole in the concealing panel 40 to 45mm in diameter in a convenient position above the cistern for the infra red sensor.

The cable to connect the sensor to the solenoid valve is 1.2 m in length.

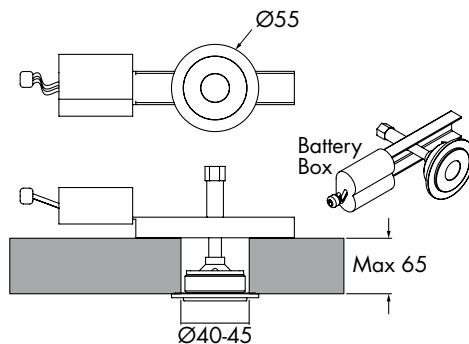

The perspex tube (8) is supplied connected to the flush valve inside of the cistern and is long enough to protrude from the cover as shown.

The cover may need to be removed from the cistern to locate the perspex tube and position it protruding through the hole.

Push the perspex tube onto the solenoid valve (4), ensuring that it is pushed fully home as a loose connection can cause the toilet to work intermittently.

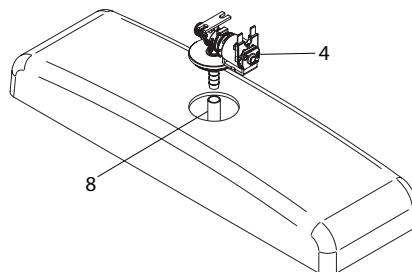

Installation Continued

Finally position the valve into the hole in the cover.

Ensure the sensor cannot be affected by any external sources such as a mirror which may create nuisance operation of the product.

The battery box is attached to the retaining bracket for the sensor as shown.

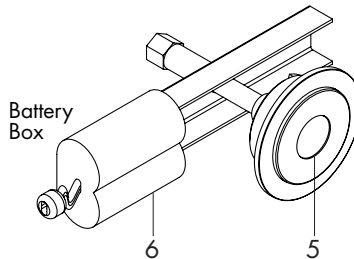

Using the cables provided connect the battery to the sensor and sensor to the solenoid valve.

Turn on the water supply and check for signs of leakage, allow the cistern to fill and check the sensor for correct operation.

Failure to observe these installation instructions will invalidate the product warranty.

Maintenance

Cleaning the Sensor

The darkened window which protects the sensor must always be clean in order to allow its correct operation.

Do not use abrasive material to avoid damaging the plastic surface.

Battery Replacement

When the battery is exhausted, the LED flashes continuously and the solenoid valve stops in the closing position.

Turn off the water supply to the cistern.

Pull apart the two halves of the connector to disconnect the battery

Remove the exhausted battery and replace it with a new one of the same type (CRP-2).

Dispose of the exhausted battery in an appropriate manner.

Warranty

The cistern and flush are covered by a 1 year warranty for any fault due to defects in material, design or workmanship.

The warranty does not cover damage caused by: incorrect installation, negligence in maintenance and use, acts of vandalism, contact with abrasive or corrosive chemicals and unsuitable cleaning instruments.

Also the presence of any dissolved compound in the water (limestone, halogen compounds, acids, etc.) leads to a loss of the warranty.

Notes

inta

Please leave this Manual for the User

To activate your product warranty please visit
www.intatec.co.uk
and click on Product Registration

inta

Intatec Ltd

Airfield Industrial Estate
Hixon
Staffordshire
ST18 0PF

Tel: **01889 272 180**

Fax: **01889 272 181**

email: **sales@intatec.co.uk**

web: **www.intatec.co.uk**

E & O.E