

NC235CP Non Concussive Basin Mounted Push Tap

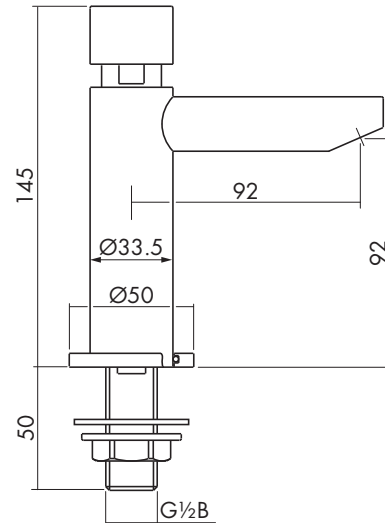

Chrome finish



Operating Conditions

Max. Operating Pressure:	6 bar
Min. Operating Pressure:	1 bar
Max. Inlet Temperature:	65°C
Flowrate:	5 l/min - with flow regulator
Timed Flow:	15 sec @ 1 bar
BS EN 816 Tolerance:	±5 sec

Water Byelaws

Your Inta tap must be connected in accordance with the Water Byelaws.

To prevent back flow and contamination of the water supply for drinking and culinary purposes the tap must provide a AUK2 or AUK3 air gap between the outlet and basin.

Inta basin taps provide a type **AUK2** air gap, for domestic use or a type **AUK3** air gap for non domestic use in hospitals and other medical premises.

In order to prevent scalding, the hot water tap should be connected to the hot water supply via a thermostatic mixing valve.

It is recommended that a service valve is installed in the cold water supply pipe or a thermostatic mixing valve having connections containing an isolating valve, in order to isolate the tap should servicing be required in the future.

Installation

The easiest way to install the tap to the basin is to do so before the basin is installed when access to the backnut is readily available.

If replacing an existing tap ensure the water supply is turned off and that the old tap is completely removed.

Fitting to Basin

Push the concealing plate onto the base of the tap before inserting the threaded section of the tap through the hole in the basin.

Fit the rubber washer and backnut onto the threaded inlet and tighten to secure the tap. Do not over tighten the backnut.

Use a swivel connector with a fibre washer (tap connector) to connect the water supply and make a water tight joint.

Apply a ring of silicone sealer on the underside side of the concealing plate and push the concealing plate to the surface of the basin.

Check the coloured indice on the push cap and ensure it corresponds with the service, red for hot or blue for cold and change as required.

Note: if replacing an existing tap the threaded inlet may be shorter than the original tap.

Turn on the water supply to the tap and run water for a couple of minutes. Check all joints for leakage.

Aftercare

Inta taps have a high quality finish and should be treated with care.

An occasional wipe with a mild washing-up liquid on a soft damp cloth followed by a thorough rinsing is all that is required.

Do not use an abrasive or chemical household cleaner as this may cause damage.

E & O.E

Intatec Limited, Airfield Industrial Estate, Hixon, Staffs, ST18 0PF

Tel: **01889 272 180** Fax: **01889 272 181** email: **sales@intatec.co.uk** **www.intatec.co.uk**