

TF178CP Adjustable Timed Flow Shower Controller with Anti-Block Feature For Concealed Pipes

For use with VR991CP and VR992CP shower heads

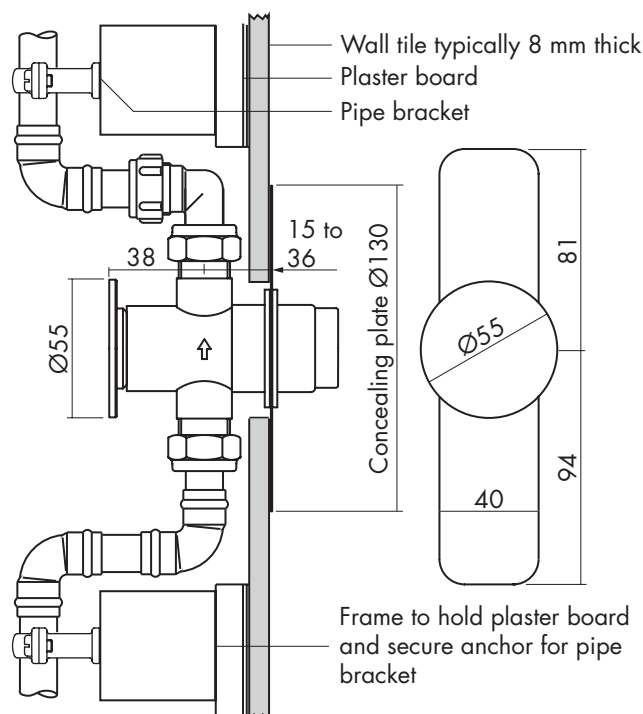

Operating Conditions

Maximum Inlet Pressure	10 bar (Static)
Minimum Inlet Pressure	0.5 bar (Dynamic)
Maximum Inlet Temperature	65°C
Timed Flow (Standard)	15±5 sec at 1 bar
Adjustable Flow Time Range	3 to 30 sec at 3 bar

Planning

The method of concealing and the structural requirements should be carefully planned before installation commences.

Access should be available to the connections of the controller and shower head, e.g. service duct.

The controller can be housed in a wall cavity but consideration should be given to damage, to wall tiles, should access be required to the joints.

The installation shown is just one example and the dimensions given are to help in the planning.

Dimensions

The body of the controller requires a minimum diameter hole of 40mm in the wall tiles.

The plaster board needs a hole 40mm wide and depending upon the method used 176mm long (88mm x 2).

Support

The pipe brackets must be of a type that hold the pipe secure as these provide the support for the controller.

The brackets should be positioned as close to the controller as possible - as shown. Additional brackets should also be fitted towards the shower head and on the supply pipe.

Installation

Flush the supply pipe before fitting the controller as debris will prevent it from working correctly.

The controller should be located immediately below the shower head approximately 1.1 to 1.2 m above the floor of the shower area.

Check the flow direction arrow to ensure that the flow will be vertically upwards to the shower head.

Concealing Plate

Lubricate the seal with washing up liquid or similar. Apply silicone mastic around the concealing plate on the rear surface 15 to 20mm in from the edge to seal the plate to the tiles to seal the plate to the tiles before pushing onto the controller.

A service ball valve must be installed in the supply pipe work or the controller must be supplied via a thermostatic mixing valve, which has supply connections containing an isolating valve, to enable the controller and shower head to be isolated for cleaning or servicing.

Intatec Limited, Airfield Industrial Estate, Hixon, Stafford, ST18 0PF

Tel: **01889 272180** Fax: **01889 272181** email: sales@intatec.co.uk web: www.intatec.co.uk

TF178CP Adjustable Timed Flow Shower Controller with Anti-Block Feature For Concealed Pipes

For use with VR991CP and VR992CP shower heads

Adjusting the Flow Time

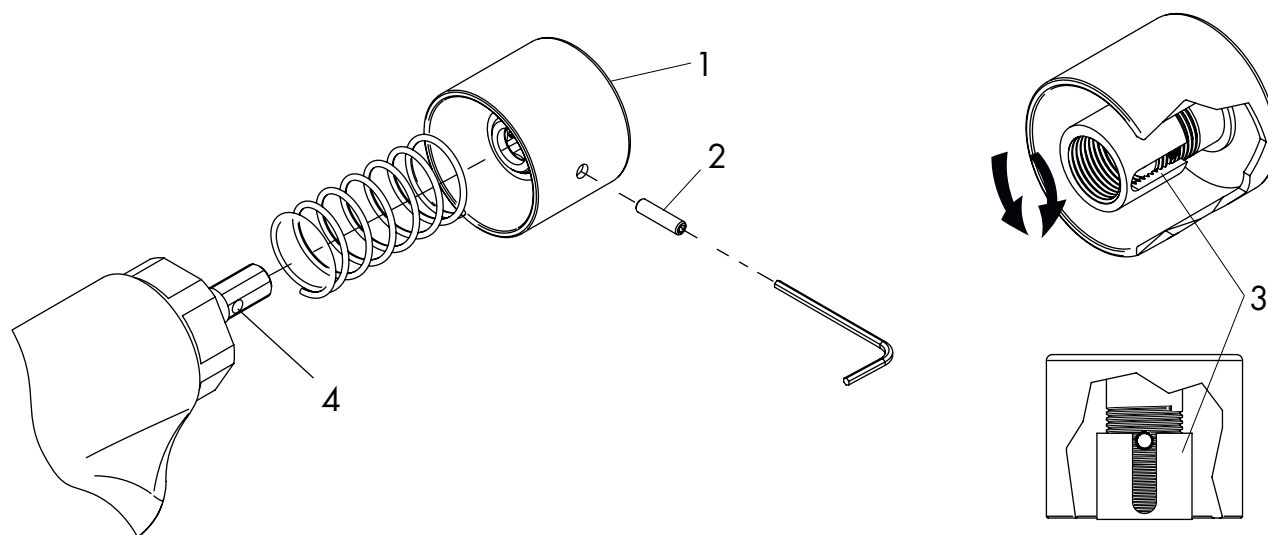

Adjusting the Flow Time

- 1 Remove the button head (1) by removing the grub screw (2) using the 1.5mm hexagon wrench provided, taking care to prevent the spring from escaping in an uncontrolled manner.
- 2 Adjustment to the timed flow can be achieved by turning the stop ring (3) clockwise to increase the length of timed flow and anti-clockwise to reduce it.
- 3 Make sure the slot in the stop ring is oriented to allow the grub screw to be returned to its original position and enter the hole in the spindle (4) of the flow cartridge.
- 4 To re-assemble the button head to the cartridge spindle in the reverse order taking care when re-fitting the spring.
- 5 Test the tap several times to confirm the desire flow time has been achieved.

Operation and Anti Block Feature

To operate the shower controller press the button head until a stop is felt, release the button and the controller will pass water for the set time.

The anti-block feature prevents water from flowing continuously even if the button is held in the pressure position thus preventing water wastage.

Aftercare

To maintain the appearance of the flow controller periodically it should be cleaned with a soft damp cloth and a mild detergent before rinsing.

The use of **abrasive** or **solvent cleaners** will **damage** the finish of the product and should **not be used**.