



DESCRIPTION:

TRADE-TEC THERMOSTATIC
BATH SHOWER MIXER WITH
FLEXIBLE SLIDE RAIL KIT &
DECK MOUNTING LEGS

CODE:

TR30024CP

MIN OPERATING PRESSURE (dynamic):

0.2 BAR

MAX OPERATING PRESSURE (static):

5 BAR

INLET CONNECTIONS:

3/4" BSP

- **THERMOSTATIC CONTROL**
- **ANTI-SCALD FAIL SAFE TECHNOLOGY**
- **SURE-SAFE MAXIMUM TEMPERATURE LIMIT**
- **ADJUSTABLE FIXING POINTS FOR RISER**
- **5 YEAR WARRANTY**

Flow Rate Graph

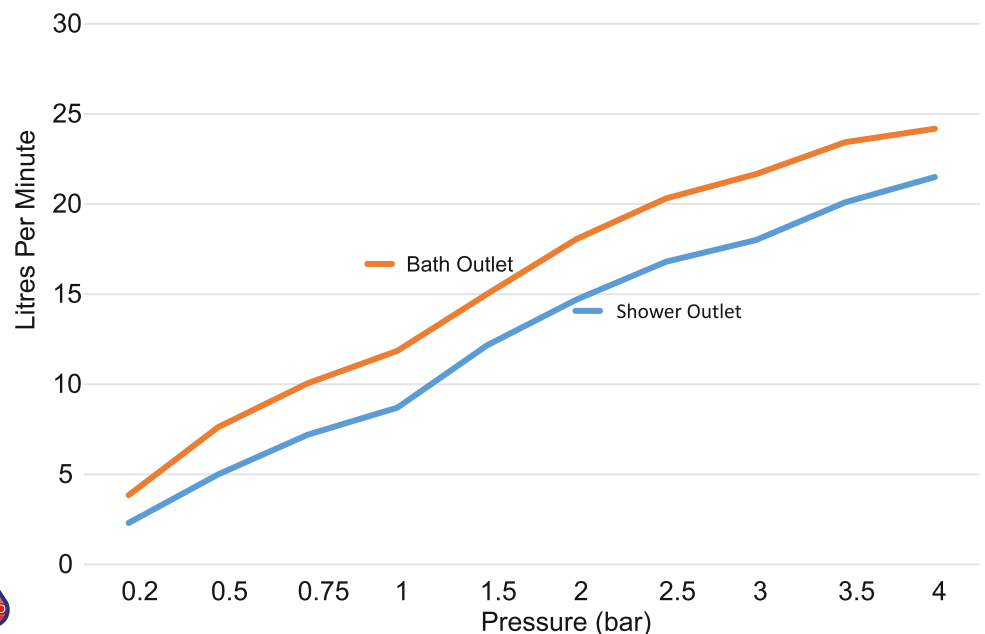

(valve only TR30010CP) (valve only TR30010CP)

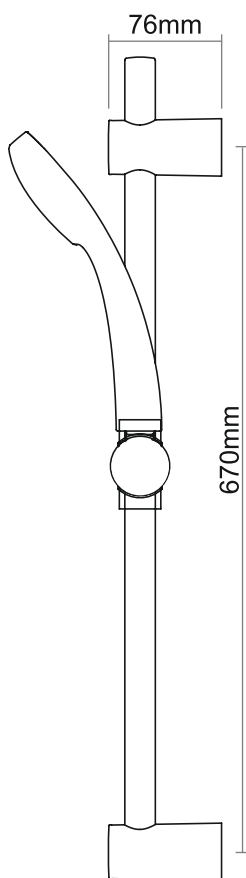
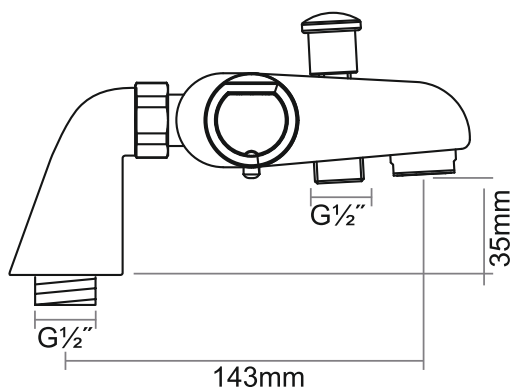
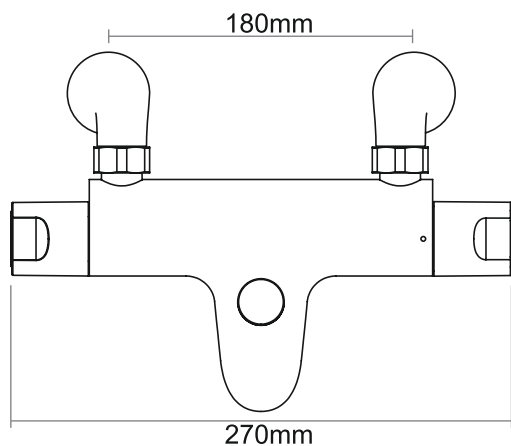

(valve only TR30010CP) (valve only TR30010CP)